



Certificate of Compliance



No. 00190708.WGLTQ98

Certificate's
Holder:

Wuhan Golden Laser Co., Ltd.
Golden Laser Building, Shiqiao 1st Rd., Economic
Development Zone, Jiang'an District, Wuhan

Certification ECM
Mark:



Product:
Model(s):

Laser Cutting Machine
(see the following annex I)

Verification to:

Standard:
EN ISO 12100:2010, EN ISO 11553-1:2008,
EN 60204-1:2018,
EN 61000-6-2:2005+AC:2005,
EN 61000-6-4:2007+A1:2011

related to CE Directive(s):
2006/42/EC (Machinery)
2014/35/EU (Low Voltage)
2014/30/EU (Electromagnetic Compatibility)

Remark: The product(s) has been verified on a voluntary basis. The product(s) satisfies the requirements of the Certification Mark of ECM, in reference to the above listed Standard(s). The above Compliance Mark can be affixed on the product(s) accordingly to the ECM regulation about its release and its use. The regulation can be found at www.entecerma.it. This Certificate of Compliance can be checked for validity at www.entecerma.it

This verification doesn't imply assessment of the production of the product(s).

Additional information, clarification about the **CE** Marking:



We attest that a TCF for the **CE** Marking process is in place. Whereas the Manufacturer is Responsible to start the **CE Marking Certification Procedure** and to perform all the necessary activities, as required by the Directive before placing the **CE** Mark on the product(s).

Date of issue 08 July 2019

Expiry date 07 July 2024

Chief Manager
Marco Morino

Deputy Manager
Amanda Payne

Ente Certificazione Macchine Srl

Via Ca' Bella, 243 – Loc. Castello di Serravalle – 40053 Valsamoggia (BO) - ITALY
☎ +39 051 6705141 📠 +39 051 6705156 ✉ info@entecerma.it 🌐 www.entecerma.it

Annex I

No. 00190708.WGLTQ98



Model(s): GF-5050, GF-6040, GF-6060, GF-1309, GF-1510, GF-1515, GF-1616, GF-1530, GF-1540, GF-1560, GF-2040, GF-2060, GF-2560, GF-2580, GF-1530T, GF-1540T, GF-1560T, GF-2040T, GF-2060T, GRF-1325, GRF-1530, GRF-1540, GRF-1560, GRF-2030, GRF-2040, GF-1530JH, GF-1540JH, GF-1560JH, GF-1616JH, GF-2040JH, GF-2060JH, GF-2560JH, GF-2580JH, GF-1530JHT, GF-1540JHT, GF-1550JHT, GF-2040JHT, GF-2060JHT, GF-2560JHT, GF-2580JHT, P2060, P2070, P2080, P3060, P3070, P3080, P30120, P2060A, P2070A, P2080A, P3060A, P3070A, P3080A, P30120A, R1410, R1440, R1550, R1800, R2000



Techncial Laser Solution

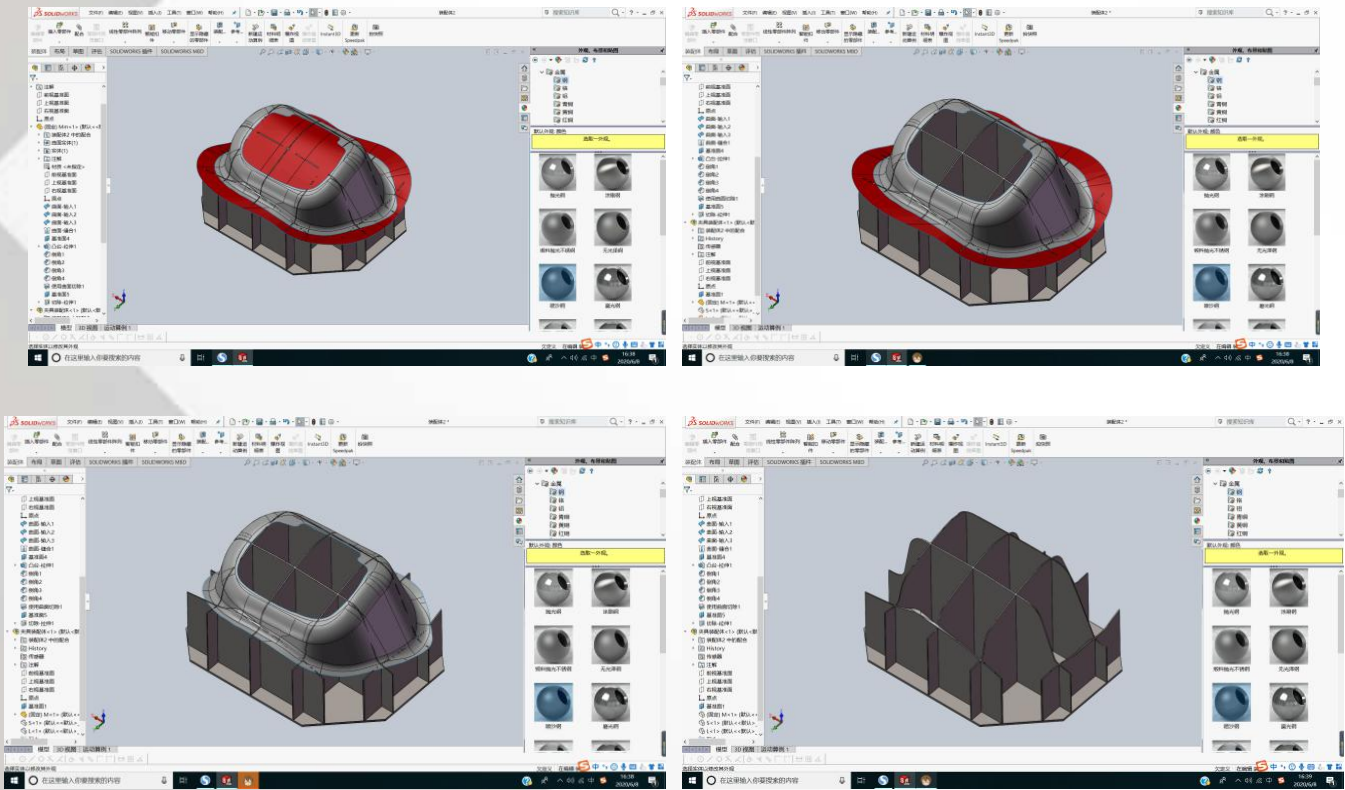

According to your product drawing, we make the robot laser cutting solution. The product uses the robot hang upside down structure with gantry, 3D laser cutting machine body, equipped with FANUC robot M-20ib and fiber laser source with good processing flexibility, low operating costs, stable and reliable quality, easy operation and maintenance features, the main features parts used imported Brand in Europe to ensure the machine's high speed, high precision, high efficiency. The product is cost-effective, can cut metal 0.5-5mm 3D materials, 0.6mm stainless steel and 5mm aluminum, the cutting accuracy is ± 0.3 mm.

2. General layout (refer to layout 20200701)

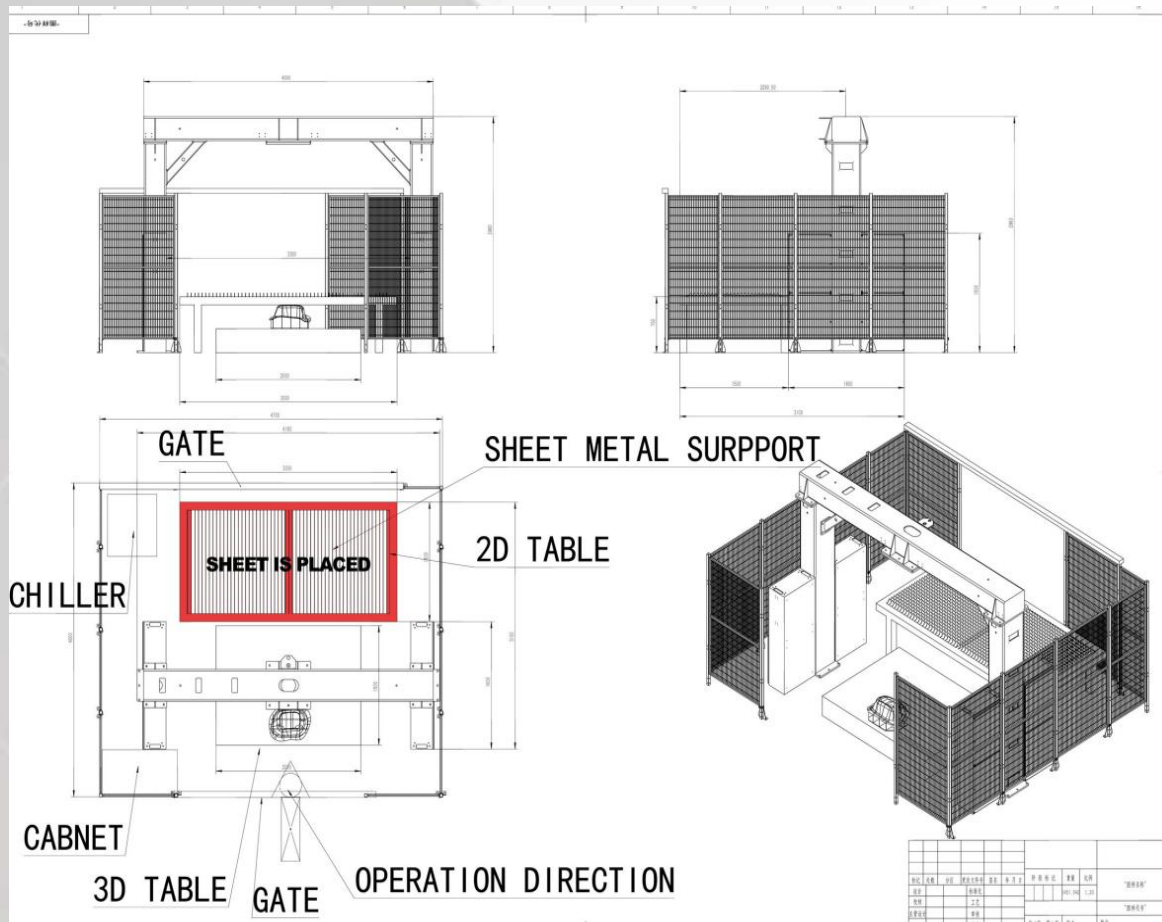
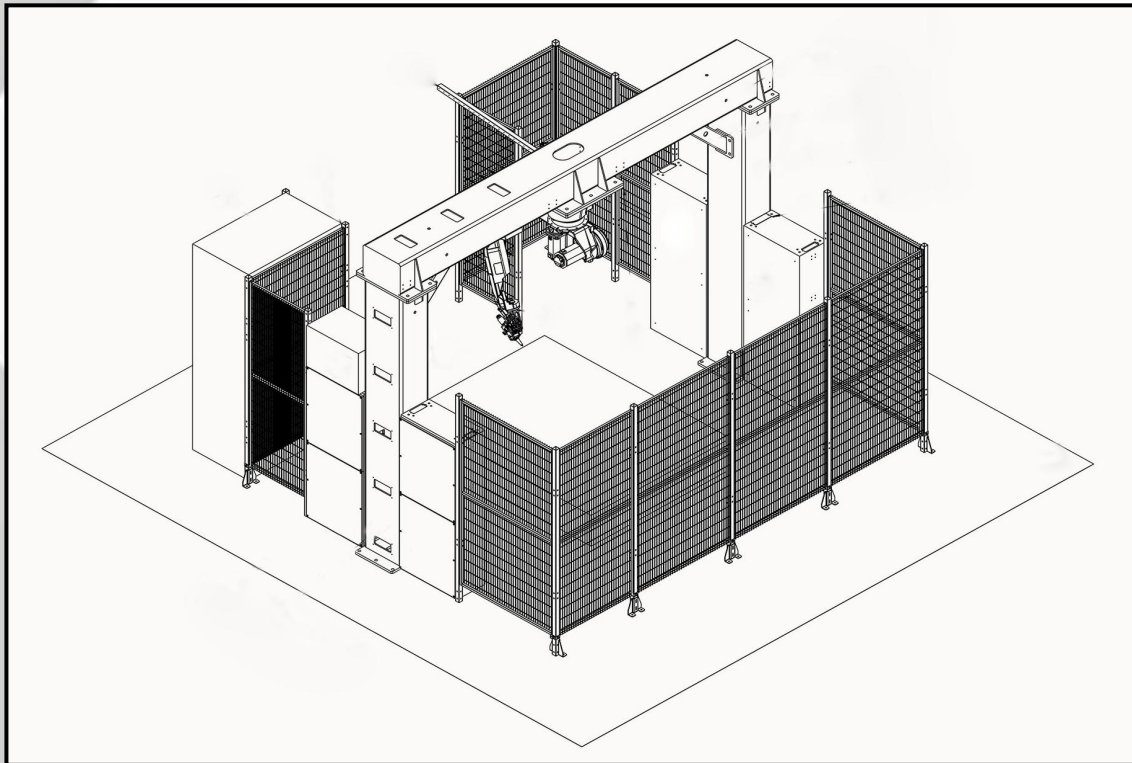

3. The Product Main Configuration

FANUC M20iB robot 3D laser cutting machine is the perfect combination of optical, mechanical, electrical and control technology in industrial applications. It mainly consists of robot, fiber laser, cutting head, inverted gantry bracket, standard working table and chiller. The whole system is highly integrated, centralized operation, operation, use, maintenance are easy. The product has good stability, fast welding speed, high precision, cost-effective advantage.

Product main configuration table

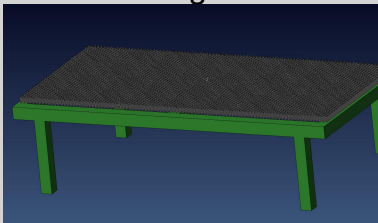
No.	Name	Model	Quantity	Remarks
1	3D cutting machine frame	Golden Laser	1 set	China
2	Robot	Fanuc M-20iB	1 set	Japan
3	Laser Source	IPG-2000W	1 set	United States
4	3D professional cutting head	BT240	1 set	Switzerland Raytools
5	Water Chiller	TF2000W	1 set	China
6	Jig-fixture and working table	Golden laser	1 set	China
7	Protection fence	Golden laser	1 set	China
8	1.5*2meters 2D plate working table 	Golden Laser	1 set	China

4. Fanuc robot arm

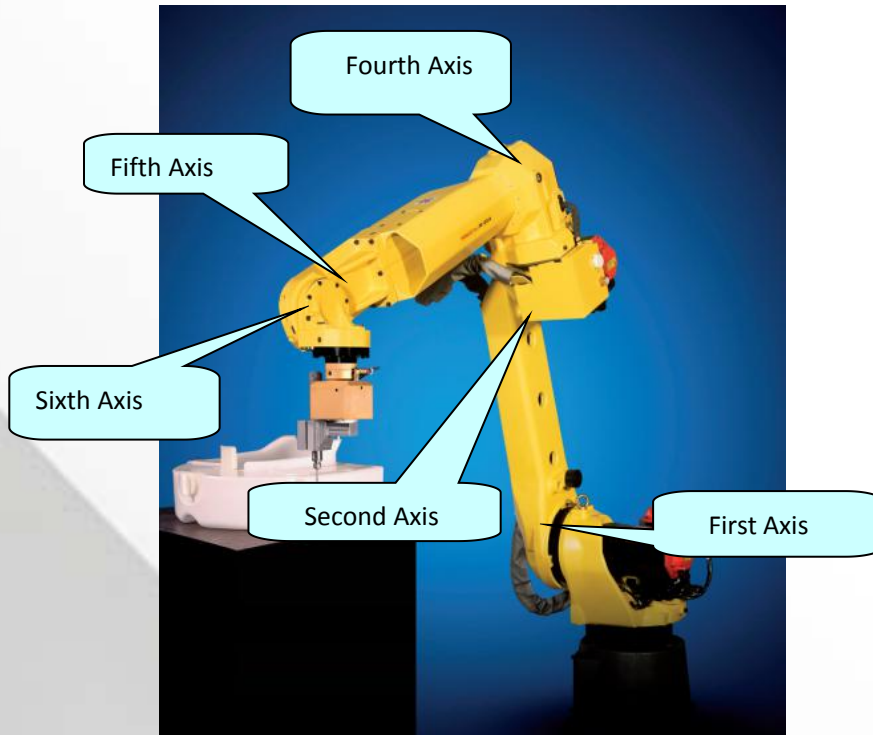

5. 3D cutting head

Cutting head use Swiss RayTools 3D cutting head; it is reliable, durable and has an advanced design. With the only extension of laser-specific connection device of Golden Laser, it is stable, durable with a higher accessibility.

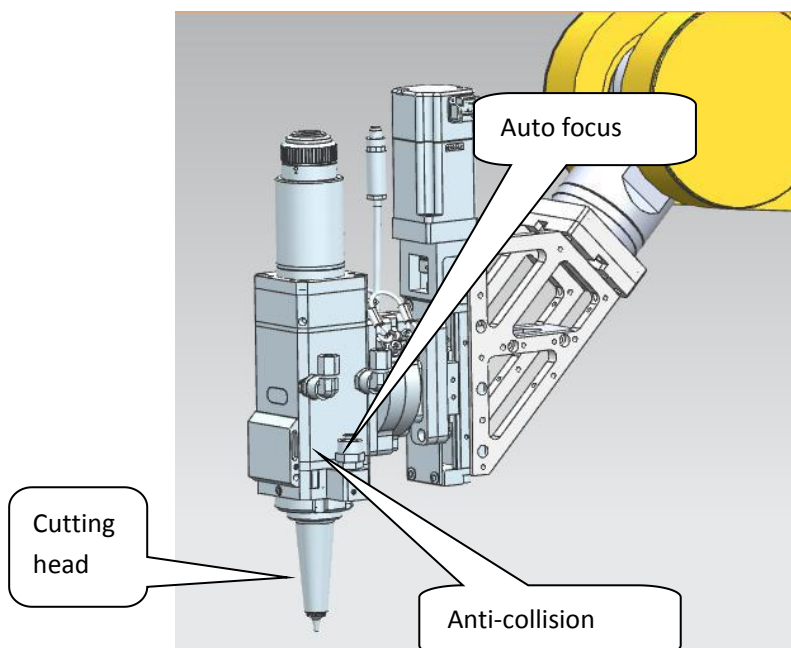

3D cutting head features:

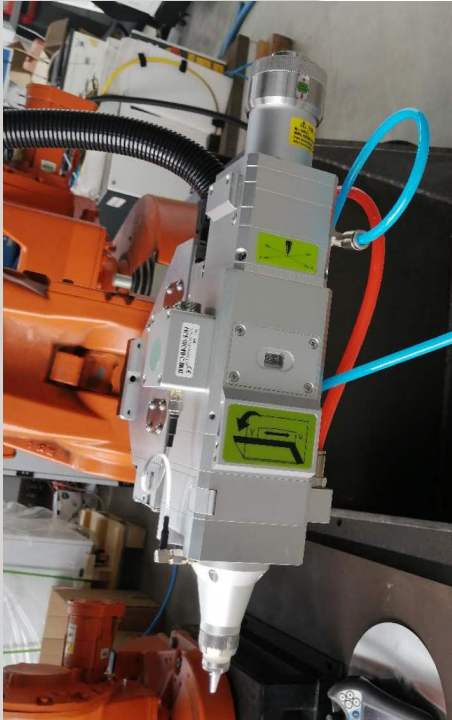

Optimized optical configuration and smooth and efficient air flow design;

Knobs focus adjustment, fine adjustment and flexible, adjustable range of 15mm, accuracy of 0.05mm;

Drawer-type lens holder, making protection lens replacement fast and easy;

Modular design with anti-collision protection and slender nozzle assembly for 3D cutting

In the event of a collision, a reliable separation of the cutting head and a timely interruption of the light can be achieved;

With a variety of optical interfaces, with a variety of lasers to adapt.

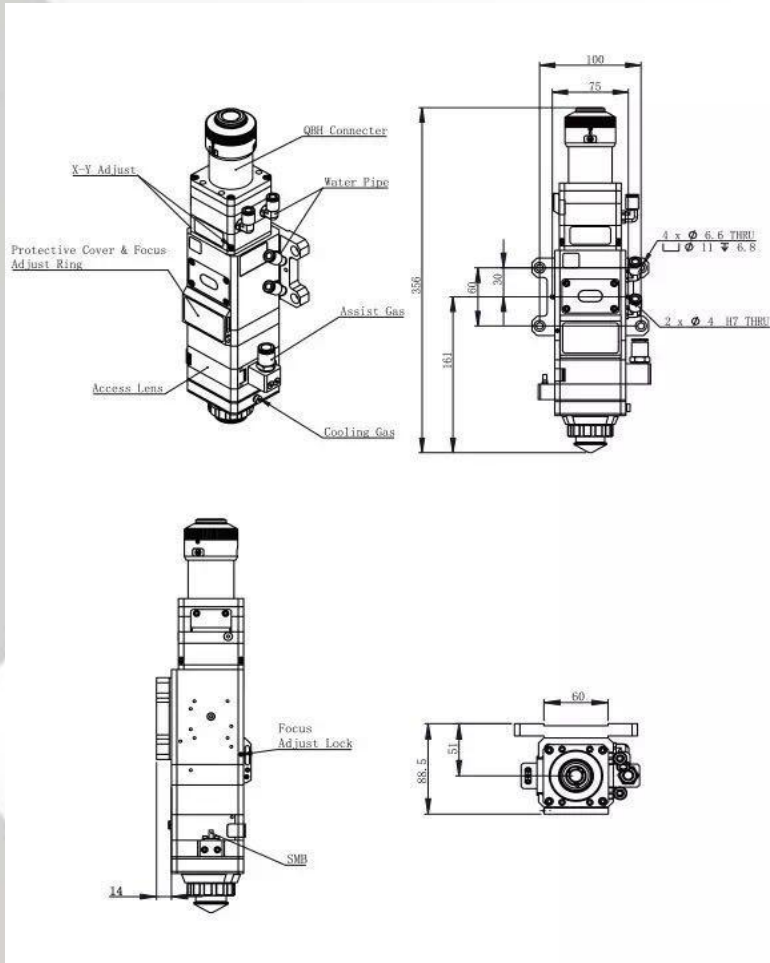
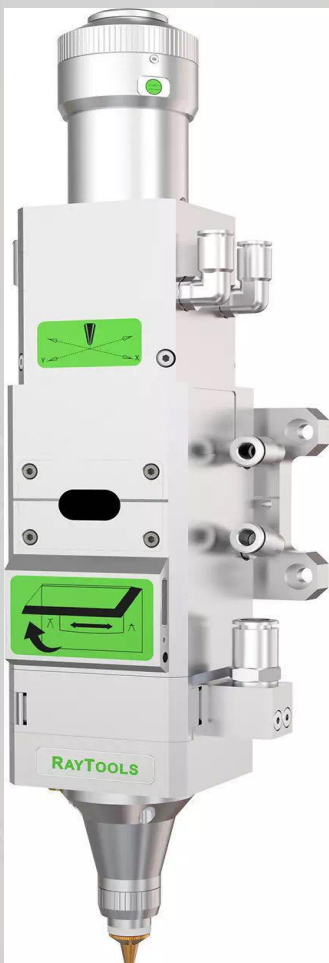

3D cutting head technical specifications are as follows:

Number	Name	Technical indicators	Unit	Remarks
1	Maximum laser power	3300	W	
2	Focus adjustment	150	mm	
3	Maximum aperture	30	mm	
4	Size	400x70x70	mm	
5	Complete system quality	Around 4	kg	

6. Water cooling system:

Water Chiller from domestic professional refrigeration equipment manufacturers Tongfei, it appointed by IPG company, it has a excellent performance and stable quality .

Features

1. System components used internationally renowned brands, to ensure that equipment has excellent quality and good reliability;

2. Use high-quality stainless steel cold water circulation pump, large flow, high head, low noise, long life; Stainless steel tanks, pipes, stainless steel valve will not rust;

3. Control system uses liquid crystal full Chinese (or English) computer controller, CPU fully automatic control, enabling man-machine dialogue, easy to operate, intuitive. Control accuracy up to $\pm 0.1^{\circ}\text{C}$; with automatic fault diagnosis function, the

fault point will be displayed directly on the screen, prompts the user to quickly deal with.

4. Provide multiple protection functions and passive alarm terminals, remote control terminals, easy to implement CNC centralized control and monitoring;

5. "Dual temperature type" precision water cooler provides a stable and precise water temperature control for the laser while providing all the way with the ambient temperature of the water temperature for cooling the lens to solve the lens in the cold water cooling caused by condensation Damage to this issue is the best choice for laser cooling machine.



6. Customer Sites

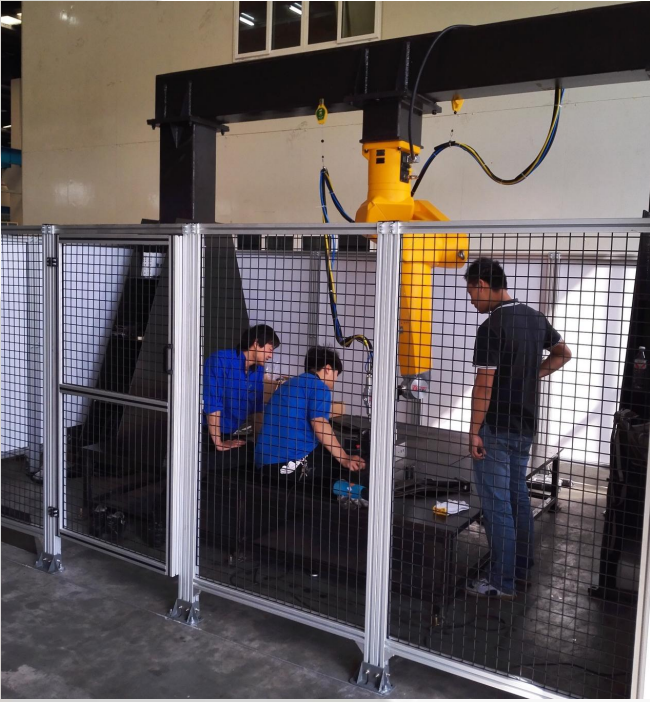

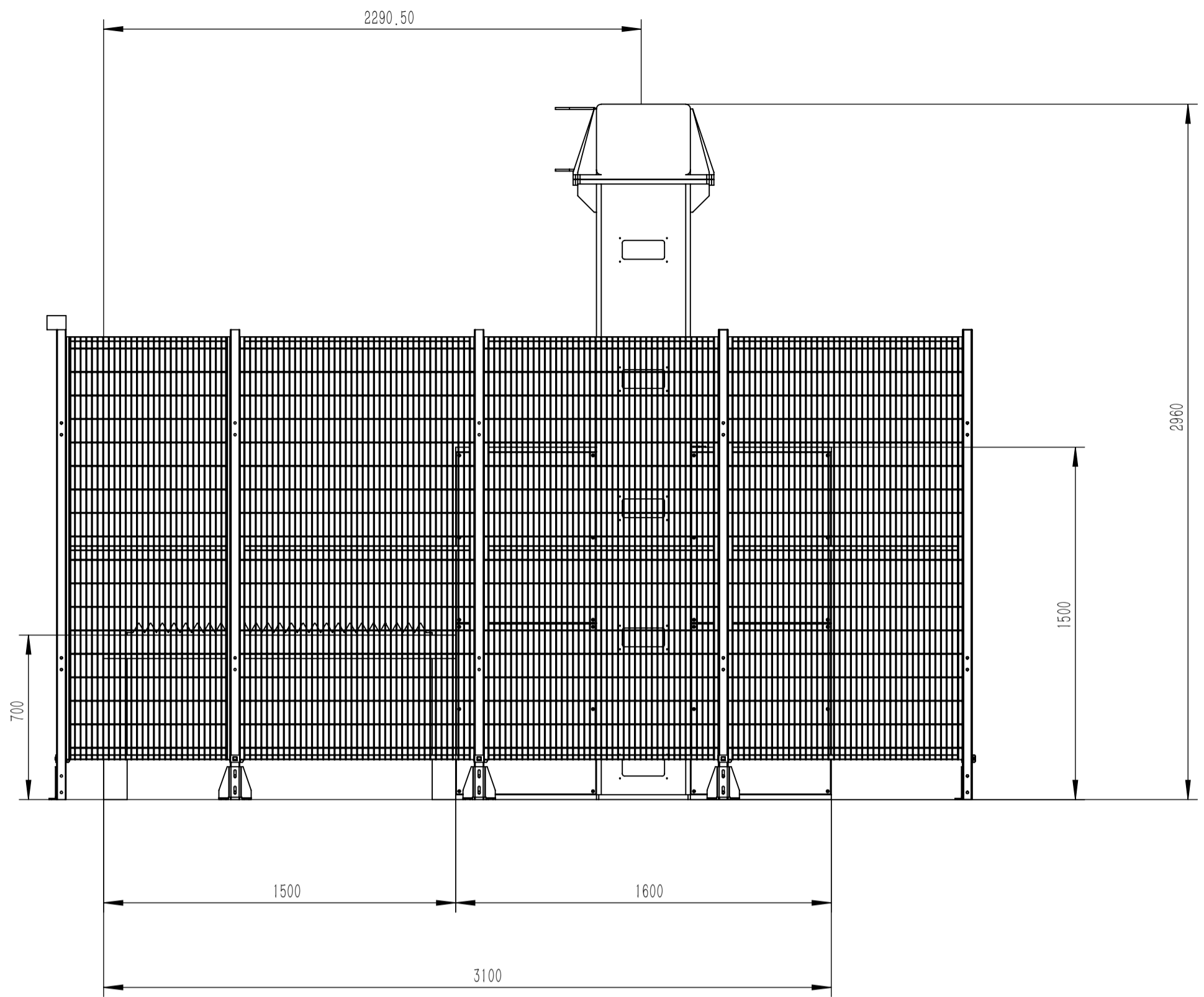
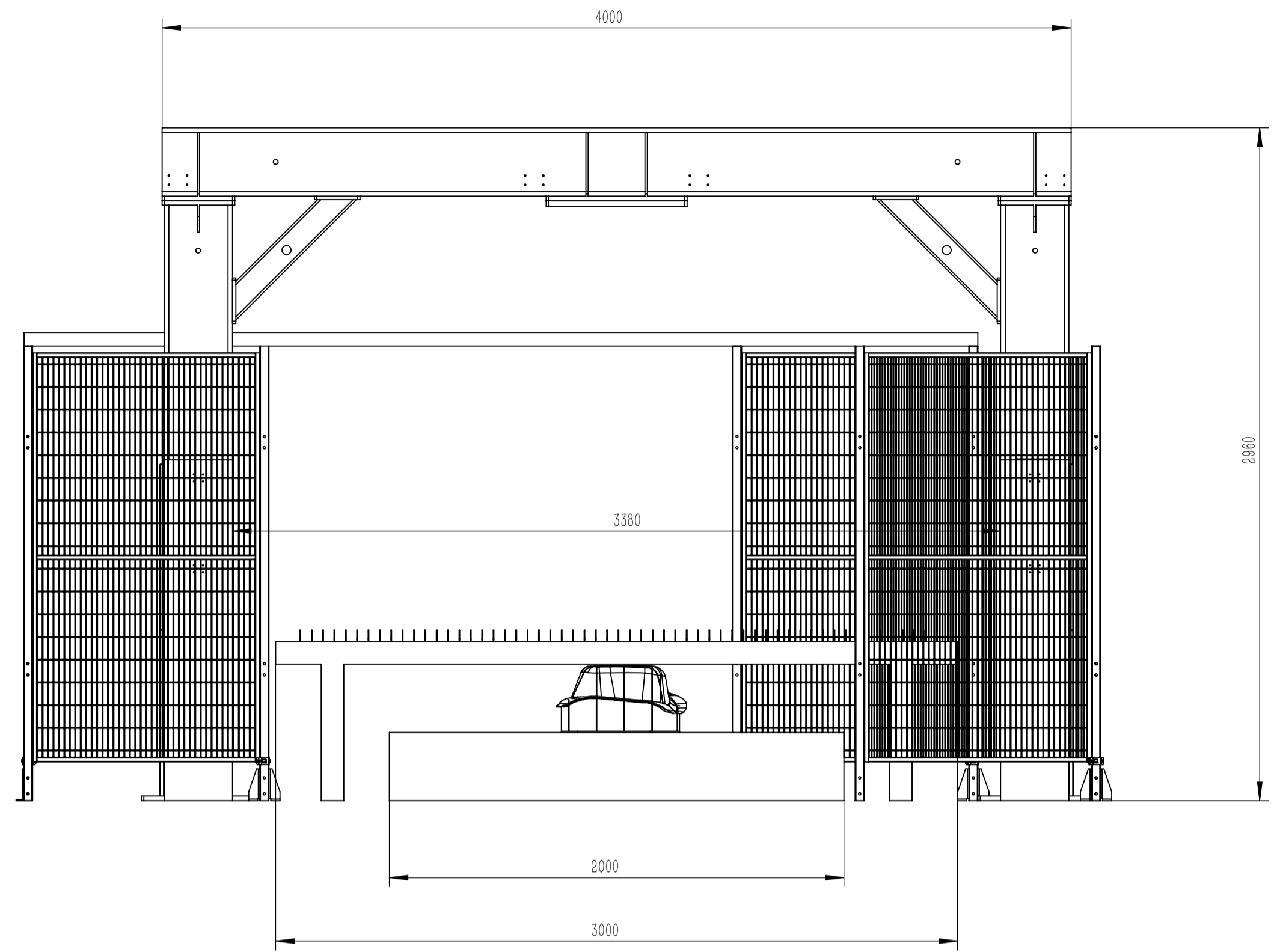

GATE

SHEET METAL SURPPORT

2D TABLE

CHILLER

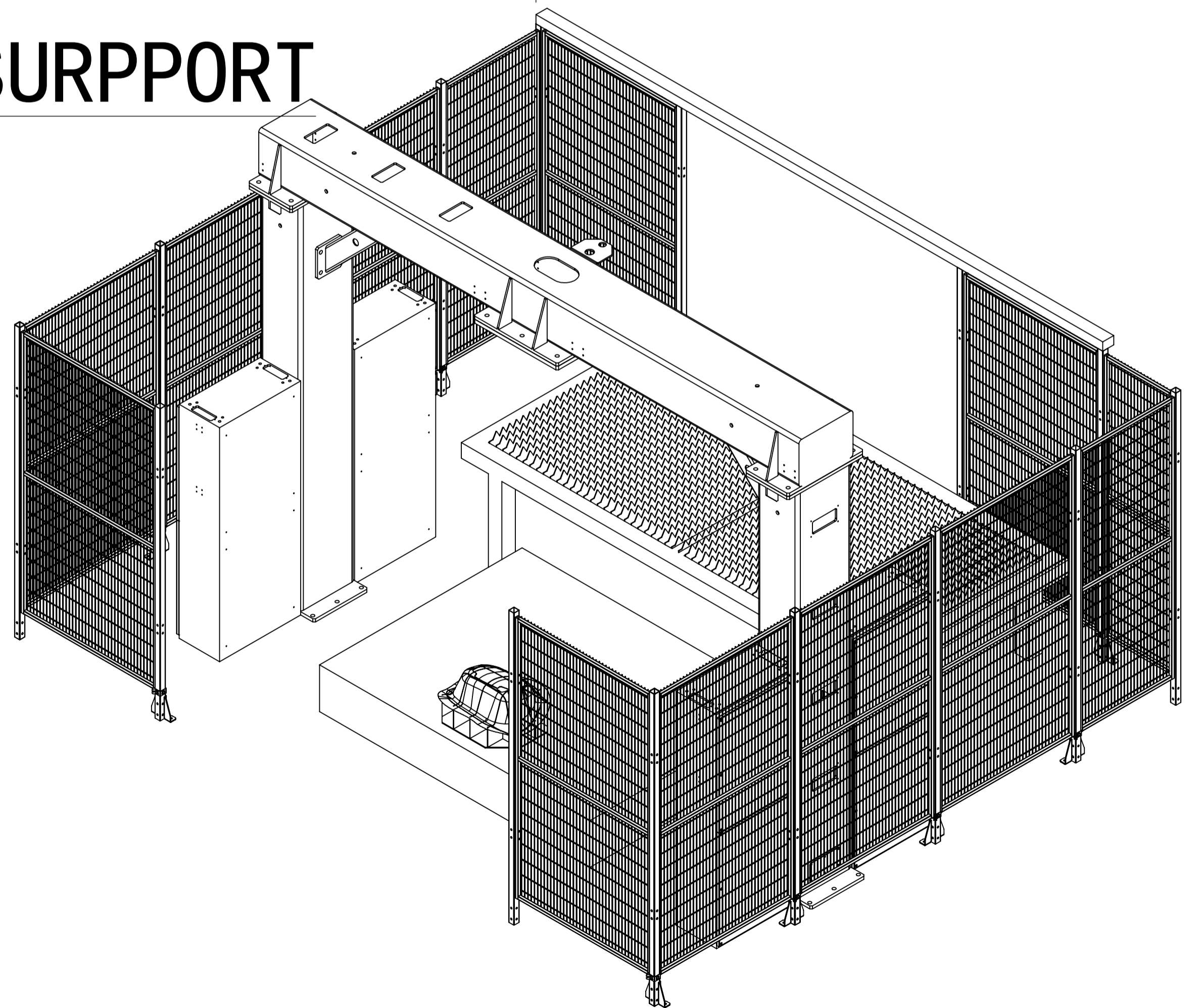

CABNET

3D TABLE

GATE

OPERATION DIRECTION

零件代号
 依(通)用件登记
 插图
 描放
 旧底图总号
 底图总号
 签字
 日期

标记	人数	分区	更改文件号	签名	年月日	阶段标记	重量	比例	“图样名称”
设计			标准化				451.042	1:20	
校核			工艺						“图样代号”
主管设计			审核						
			批准						
共 1 张 第 1 张						版本			替代

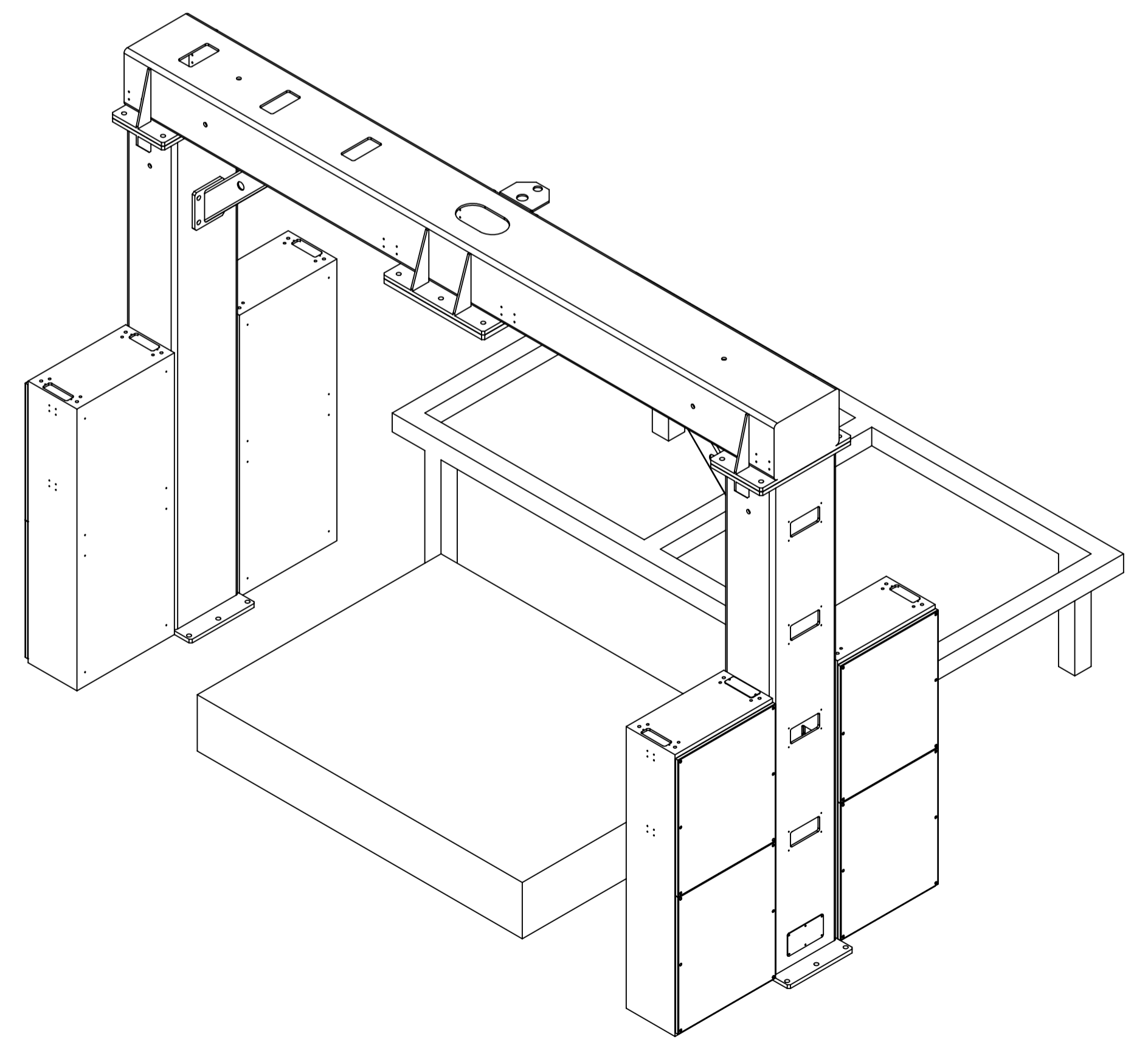
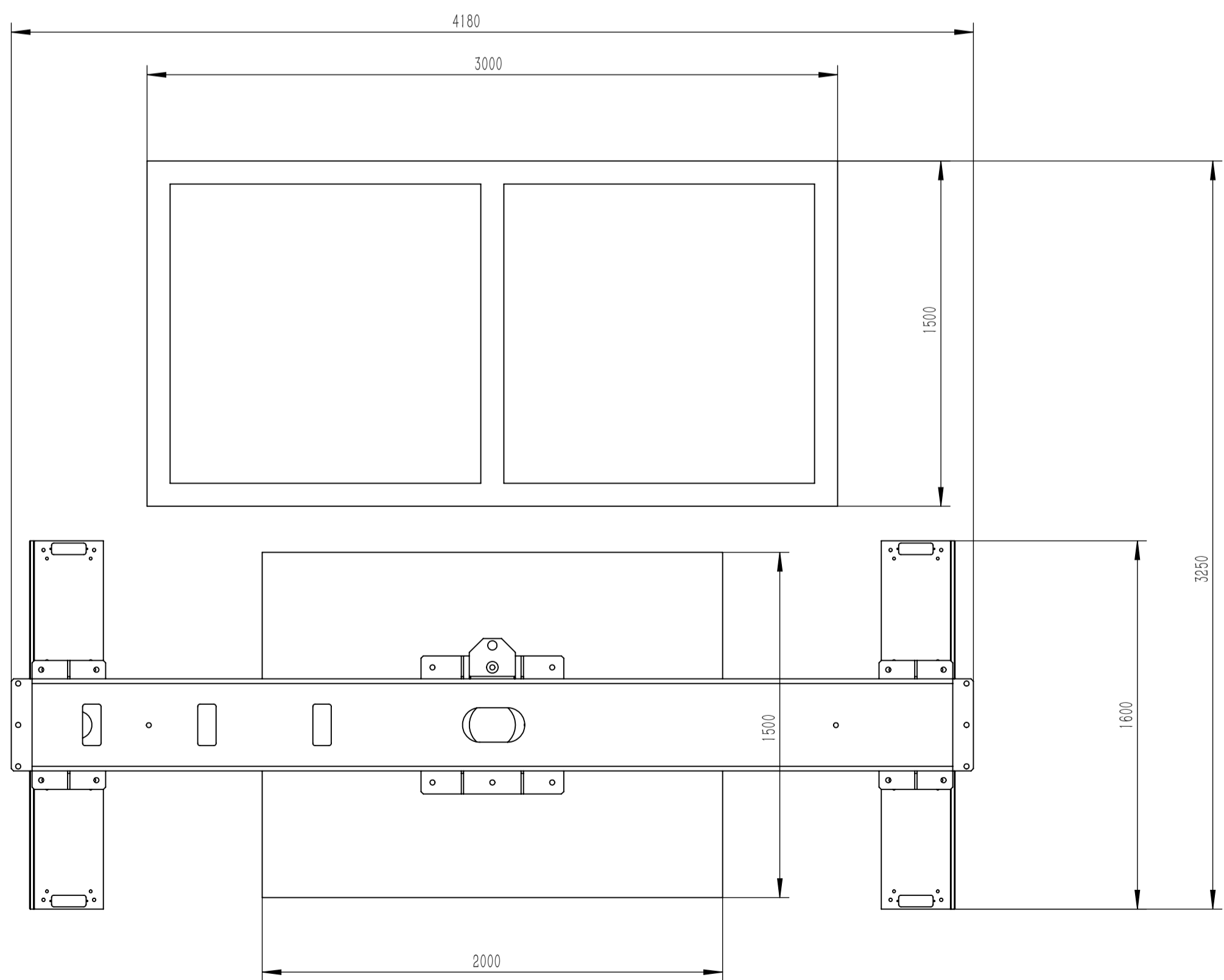
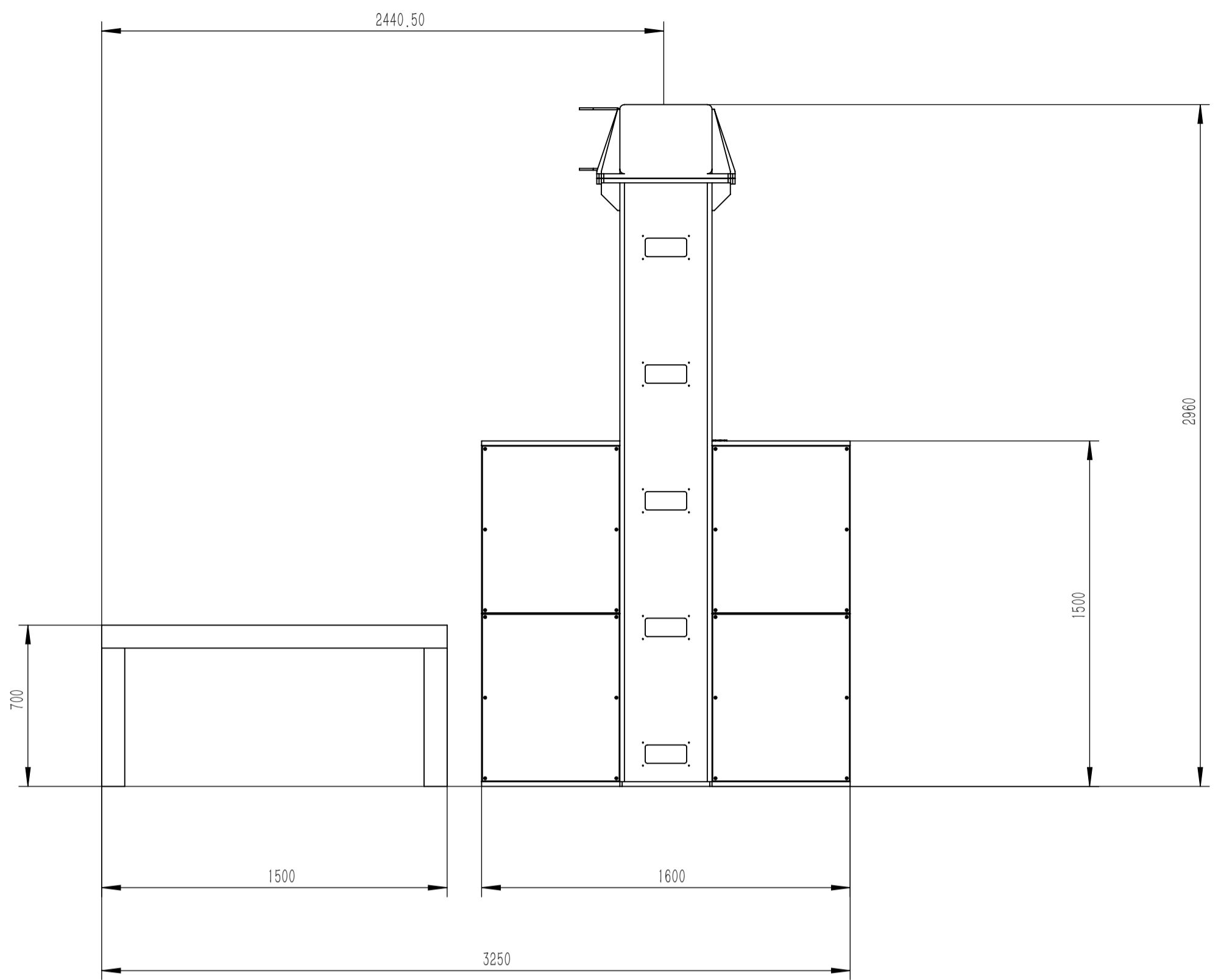
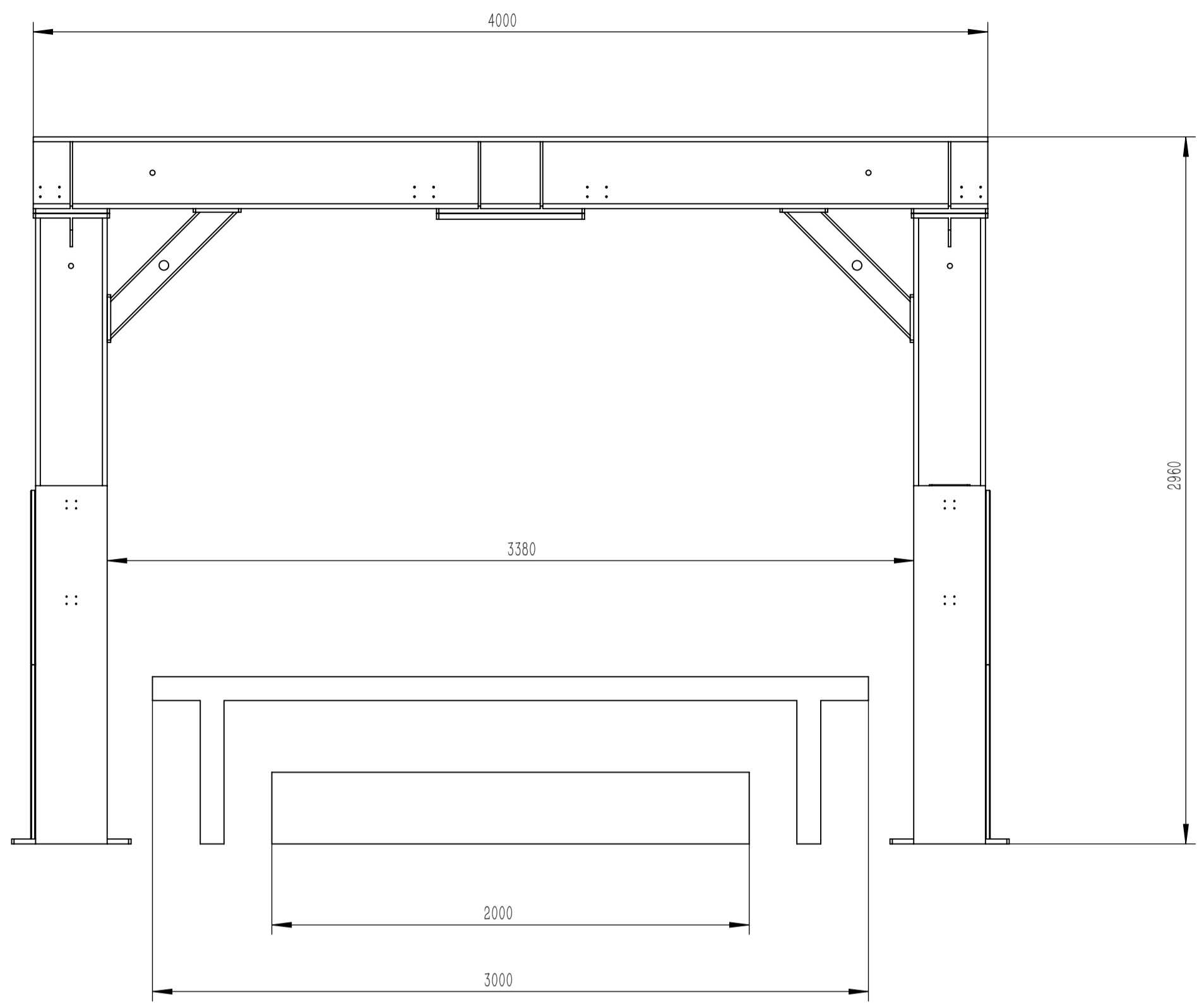

零件代号
 催(通)用件登记
 描图
 描放
 旧底图总号
 底图总号
 签字
 日期

标记	处数	分区	更改文件号	签名	年月日	阶段标记	重量	比例	图样名称
设计			标准化				284.858	1:20	
校核			工艺						
主管设计			审核						共 1 张 第 1 张 版本 替代
			批准						